



Cruciform bollard

1.Product description

Nominal size of single cruciform bollards: 50mm, 75mm 100mm

Nominal size of double cruciform bollards: 50mm, 75mm, 100mm, 125mm, 150mm, 175mm, 200mm, 250mm, 300mm

Our bollards can be used for steel cables and ropes.

Nice shaped, good quality and with very low maintenance.

LR,BV,CCS Certificate could be provided

We also customize bollard products for special requirements.

2.Core attributes:

- A. High quality SG iron as standard
- B. Strong and durable designs
- C. Very low maintenance
- D. Large line angles possible
- E. Standard and custom anchors available
- F. Specification and Type
- G. Bollards are manufactured in a wide range of shapes, sizes and capabilities. In general, the

type bollard should always well as the general size (i.e. height, head size, base size, etc) and load capacity.

Every enquiry from you will receive our prompt attention. kindly welcome to contact me directly.

3.

Drawing

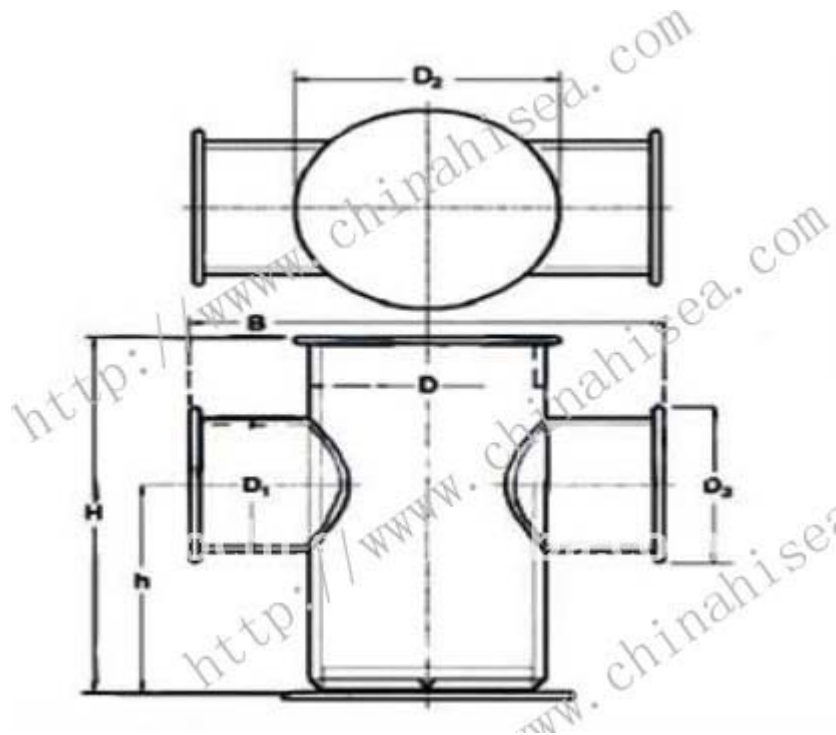

Nominal Dia.(mm)	Dimension(mm)							Weight(kg)	Wire Rope D
	H	h	B	D	D1	D2	D3		
150	480	280	460	165	114	206	158	33	16
200	560	320	520	216	165	256	206	60	22
250	640	360	610	267	216	308	256	102	28
300	680	380	660	318	267	360	308	154	34
350	720	420	720	355	267	400	312	186	38